

# INDIANA INNOVATION *and* HIGH PERFORMANCE SUMMIT 2019

**THRIVING AND  
ACCELERATING**

**Innovative, High Performance  
Design, Construction  
And Operation  
In the Built Environment**

## **PARTNER ORGANIZATIONS**



**INDIANA**



Indiana Society for Healthcare Engineering



Executive Women in Healthcare

ACHE F2F CEs, AIA LU/HSWs, GBCI CEs LEED Specific BD+C, O+M, ID+C and PDHs

# 2019 SESSION AGENDA

9:00 AM **REGISTRATION / EXPO HALL OPENS**

9:30 - 10:30 / 11:00 AM **EDUCATION TRACKS** (Concurrent Sessions)

**TRACK A - SALON E** **Evidence-Based Design and Evidence-Based Medicine**  
Regional Hospital Executives will discuss upcoming projects and how they are aligning Evidence-Based Design and Evidence-Based Medicine to design a more efficient and higher quality patient-centered healthcare delivery model.  
**1.5 ACHE F2Fs, AIA LU/HSWs, PDHs, GBCI CEs**

**TRACK B - SALON B** **LEED v4.1**  
National and Regional thought leaders will provide their perspectives on the recently launched LEED v4.1. They will discuss how it is impactful to the proper design of sustainable and resilient Corporate, Higher Education, Mission Critical and Healthcare facilities, while additionally providing considerable value to building Owners and Operators.  
**1 AIA LU, PDH, GBCI CE LEED Specific (BD+C, ID+C)**

11:30 AM - 1:00 PM **KEYNOTE LUNCH PRESENTATION**  
**GRAND BALLROOM** **The Digital Transformation of the Design and Construction Industry**  
New technologies are rapidly transforming all global industries. The Keynote Speaker will share highlights of his team's research on the digital transformation of design and construction and provide examples of innovative ways firms are applying these tools and practices to benefit all parties, particularly for healthcare facilities.  
**1.5 AIA LUs, PDHs, GBCI CEs LEED Specific (BD+C)**

2:00 - 3:00 / 3:30 PM **EDUCATION TRACKS** (Concurrent Sessions)

**TRACK A - SALON E** **Management and Prevention of Hospital Acquired Infections**  
Healthcare Thought Leaders will seek to inform hospital Designers, Administrators and Leadership about the causes of hospital acquired infections and how they affect the quality, financial health and safety of healthcare facilities.  
**1.5 ACHE F2Fs, AIA LU/HSWs, PDHs, GBCI CEs**

**TRACK B - SALON B** **How to Introduce Better Design into the Design Process**  
This collaborative panel of Corporate and Healthcare Facility and Design leaders will discuss benchmarking, ASHRAE 209 and the advantage an integrative process offers to project teams as well as the positive impact the outcomes will have on the most important building use, the people within.  
**1 AIA LU, PDH, GBCI CE LEED Specific (BD+C, O+M)**

3:00 PM - 4:30 PM **NETWORKING HAPPY HOUR**  
Cocktails and hors d'oeuvres will be provided

# CONFERENCE MAP

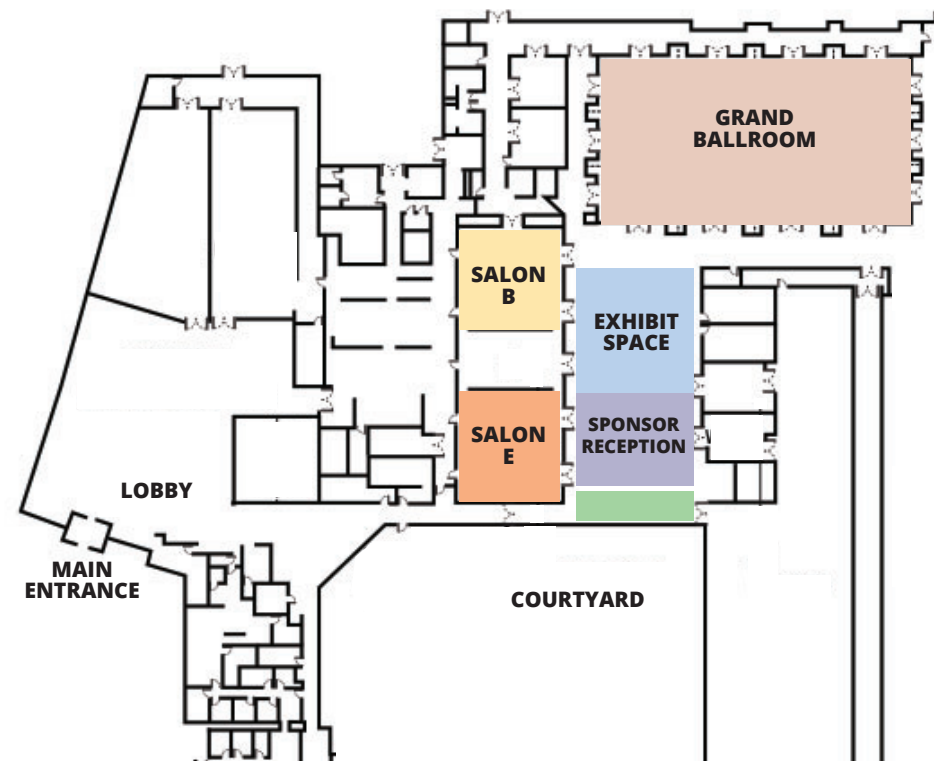

- REGISTRATION**
- EXHIBIT SPACE**
- GRAND BALLROOM**
- SALON E**
- SALON B**
- SPONSOR RECEPTION**

9:30 AM - 11:00 AM  
OWNER'S PERSPECTIVE

1.5 ACHE F2FS, AIA LU/HSWs, PDHs, GBCI CEs

TRACK A - SALON E

Introduction of Panelists

**JEREMY FORTIER, CHC, PMP, LEED AP**  
Director of Planning, Design and Construction, Ascension / St Vincent

EVIDENCE-BASED DESIGN AND EVIDENCE-BASED MEDICINE

Regional Hospital Executives will discuss upcoming projects and how they are aligning Evidence-Based Design and Evidence-Based Medicine to design a more efficient and higher quality patient-centered healthcare delivery model.



**SHEILA F. CAHNMAN, FAIA, FACHA, LEED AP**  
President, JumpGarden Consulting, LLC

Sheila Cahnman has devoted her over 35-year career to planning innovation for healthcare facilities. President of JumpGarden Consulting, Sheila previously led three award winning regional and national healthcare architecture practices, designing major medical centers world-wide. She is both an AIA and ACHA Fellow and was named one of the top twenty-five most influential in healthcare design by Healthcare Design Magazine 2010. Sheila has presented at 40 conferences and published over 30 articles focusing on current trends.



**MIKE CASTOR**  
Executive Director of Design and Construction,  
Indiana University Health

Bringing 30 years of healthcare experience to the role, Mike leads a team of professionals managing capital projects at all hospital sites across the state for IU Health. Prior to serving as the owner's technical representative for Indiana University Health Bloomington Regional Academic Health Center, Mike was a principal in a leading Indianapolis based architectural / engineering design firm working with healthcare and life sciences clients from across the Midwest.



**MICHAEL KUHN, FACHE**  
Director of Nursing, Community Hospital East

Michael has experience in multiple healthcare related fields with key competencies in new hospital and facility design, strategic planning, operations, financial management, population health, business development, marketing, governance, building collaborative teams and physician relations.



**JEREMY FORTIER, CHC, PMP, LEED AP**  
Director of Planning, Design and Construction,  
Ascension / St Vincent (Moderator)

Jeremy's primary focus is to ensure the overall effectiveness of a facility's design and construction and that they both align with the mission and strategy of Ascension, Medxcel, and the Health Ministries. He emphasizes the establishment of the system's productive role in significant capital projects, regional relationships, and nationwide coordination of all the Construction Programs.

9:30 AM - 10:30 AM  
HIGH PERFORMANCE DESIGN

1 AIA LU, PDH, GBCI CE LEED Specific (BD+C, ID+C)

TRACK B - SALON B

Introduction of Panelists

**BRYAN SCHENCK, LEED AP BD+C, WELL AP**  
LEED Specialist, HEAPY

LEED v4.1

National and Regional thought leaders will provide their perspectives on the recently launched LEED v4.1. They will discuss how it is impactful to proper design of sustainable and resilient Corporate, Higher Education, Mission Critical and Healthcare facilities, while additionally providing considerable value to building Owners and Operators.



**HANNAH FLECK, PE, LEED AP BD+C**  
Sustainability Engineer, Guidon Design

Hannah has worked on building and infrastructure projects throughout the country. She brings her enthusiasm and expertise of sustainable design strategies to every project. Growing up in the rural mid-west inspired a lifelong connection to the natural world. She holds a Bachelor of Science in Engineering and Master of Science from the University of Iowa and currently serves as the Secretary of the USGBC Indiana Market Leadership Advisory Board.



**STEFANIE YOUNG**  
Vice President, Technical Solutions, USGBC

Stefanie assists large building portfolio owners through sizable technical issues and offers streamlining capabilities when implementing multiple building certification programs at the local, regional, and global level. She cultivates market sector expertise and uses her extensive knowledge of USGBC and LEED to deliver solutions for complicated issues while making the process as smooth as possible for the customer.



**BRYAN SCHENCK, LEED AP BD+C, WELL AP**  
LEED Specialist, HEAPY (Moderator)

Bryan is responsible for energy analysis, energy auditing and energy modeling for all markets, as well as mechanical systems design focusing on retrofits and data centers. He is a leader in providing energy analysis that includes on-site measurement and verification, comprehensive energy modeling and simulating design alternatives for energy comparison.

PROGRAM INSIGHTS



11:30 AM - 1:00 PM

KEYNOTE LUNCH PRESENTATION

1.5 AIA LUs, PDHs, GBCI CEs LEED Specific (BD+C)

GRAND BALLROOM

Welcoming Remarks

**MICHAEL BERNING, PE, CEM, LEED FELLOW, HEAPY**

THE DIGITAL TRANSFORMATION OF THE DESIGN AND CONSTRUCTION INDUSTRY

New technologies are rapidly transforming all global industries. The Keynote Speaker will share highlights of his team’s research on the digital transformation of design and construction and provide examples of innovative ways firms are applying these tools and practices to benefit all parties, particularly for healthcare facilities.



**STEPHEN JONES**  
Senior Director, Industry Insights Research  
Dodge Data & Analytics (formerly McGraw Hill Construction)

At Dodge, Steve Jones focuses on how emerging economic, practice and technology trends are transforming the global design and construction industry. In addition to hundreds of global speaking engagements and numerous articles in industry publications, he produces Dodge Data & Analytics’ **SmartMarket Reports** on key industry trends, which are frequently cited as authoritative references.

Steve holds an MBA from Wharton and a BA from Johns Hopkins. He has a track record of active leadership in many industry initiatives and serves as a judge for numerous industry awards.

Before joining Dodge, Steve was Vice President of Primavera Systems (now part of Oracle), the global leader in project management software. Prior to that, Steve spent 19 years in creative and management roles with top architectural/engineering firms, most recently as a Principal and Board of Directors member with Burt Hill, one of the largest A/E firms in the US (now merged with Stantec).

PROGRAM INSIGHTS

PARTNER ORGANIZATIONS

HEAPY, a nationally recognized firm known for its Vision to “Build a more resilient and sustainable society”, provides Strategic Planning, MEP and Technology Systems Design, Commissioning, Sustainability and Energy Services for the Healthcare, Higher Education, Corporate and Government markets. HEAPY has 6 offices and over 220 HEAPY colleagues in Indiana, Ohio and North Carolina. HEAPY is recognized as the 35th largest Engineering Firm, a Top 25 Green Design Firm and a Top 15 Commissioning Firm.



AIA Indiana is a statewide non-profit association that represents roughly 750 architects from four local sections which includes Indianapolis, Fort Wayne, Northern Indiana, and Southern Indiana. The chapter encourages collaboration and provides support for all architects in Indiana through fellowship with a goal of advancing the profession.

Indiana Healthcare Executives Network (IHEN) is proud to partner with our Platinum Sponsor - HEAPY - for the Indiana Innovation and High Performance Summit. IHEN is the local Indiana chapter for our national ACHE (American College of Healthcare Executives) parent organization. IHEN exists to spark growth, build networks and encourage our members to continually educate themselves on the ever-changing world of healthcare. IHEN partners with local organizations to inspire creativity and help our members expand their horizons. HEAPY has played a large role in the IHEN community and we are thankful to have them as a part of our network.



The U.S. Green Building Council transforms buildings into more efficient and healthy places to live, learn, work, and play. A passionate group of volunteers, staff, and USGBC members are working every day to advance our shared mission of green buildings for all within this generation. We invite you to join us as we green Indiana together.

ISHE is a resource for you and your hospital, formed in order to develop solutions to common problems, saving you and your hospital time and money. ISHE members are professionals who are interested in personal and professional development.



Executive Women in Healthcare (EWHC) is here to support and learn from one another to acquire comprehensive knowledge of the Healthcare industry. We provide educational opportunities, personal growth and professional development to become agent’s of change for Indiana’s Healthcare industry.

2:00 PM - 3:30 PM

OWNER'S PERSPECTIVE

1.5 ACHE F2FS, AIA LU/HSWs, PDHs, GBCI CEs

TRACK A - SALON E

Introduction of Panelists

**KARIN KENNEDY**  
Vice President of Quality and Patient Safety, Indiana Hospital Association

MANAGEMENT AND PREVENTION  
OF HOSPITAL ACQUIRED INFECTIONS

Representing some of Indiana’s finest Universities, these Panelists will provide their perspective on the use of High Performance systems and processes across their campuses. Design concepts such as energy efficient systems and requirements for Sustainability and LEED certification will be discussed as they talk about their upcoming projects.



**PAULA CLASSICK, MSN, RN, LSSBB, CPHQ**  
Director of Quality and Patient Safety, St Vincent Hospitals  
Paula oversees a team of quality coordinators and data analysis whose roles support the organization through the creation and maintenance of dashboards; facilitation of PI committees, review and analysis of HAC events and ongoing regulatory readiness.



**JOE FERDELMAN, PE, HFDP, LEED AP BD+C**  
Healthcare Practice Leader, HEAPY  
Joe provides guidance to the firm’s engineering staff on matters regarding the latest innovations in healthcare design and the development of design tools, codes and overall industry insight. HEAPY’s healthcare practice does over \$400 million in design per year. Projects range from replacement hospitals to outpatient clinics.



**SUZANNE KOEHLER, FACHE**  
VP Facilities Development and Support Services, Community Health Network  
Suzanne’s primary focus of her work was the redevelopment of the Community Hospital East campus, representing the largest capital project of the Network, and including work with the State of Indiana in development of services and space to accommodate the new Neuro-Diagnostics Institute.



**LISA RUDOLPH, MHA, BSN, RN, CPHQ, LSSBB**  
Director Infection Control, St Vincent Indianapolis Hospital  
Lisa is responsible for managing and supervising all activities related to the prevention, control, documentation and reporting of acquired infections and communicable diseases. She is setting standards and evaluating compliance for practices that are associated with the prevention and control of healthcare-associated infections.



**KARIN KENNEDY**  
VP of Quality and Patient Safety, Indiana Hospital Association (Moderator)  
Karin provides strategic direction, leadership and project management to IHA for the Association’s goals related to quality and patient safety, including but not limited to statewide and national efforts related to preventing patient harm, improving community health, increasing patient and family engagement, and leading a culture of safety.

2:00 PM - 3:00 PM

HIGH PERFORMANCE DESIGN

1 AIA LU, PDH, GBCI CE LEED Specific (BD+C, O+M)

TRACK B - SALON B

Introduction of Panelists

**STEVE OSBORN, PE, SE, FSMPS, CPSM**  
Founder - President, CE Solutions

HOW TO INTRODUCE BETTER DESIGN  
INTO THE DESIGN PROCESS

This collaborative panel of Corporate and Healthcare Facility and Design leaders will discuss benchmarking, ASHRAE 209 and the advantage an integrative process offers to project teams as well as the positive impact the outcomes will have on the most important building use, the people within.



**GREG GRAHAM**  
Director of Facilities Planning, Ball State University  
Greg oversees a staff that includes Architects, Interior Designers, Draftspersons and the Sign Shop. Facilities’ Planning provides architectural and design services to the University and manages the design with outside design consultants.



**SARAH WOOD, AIA, NCARB, LEED AP BD+C**  
Director of Sustainability, RATIO Architects  
Sarah has over a decade of experience driving change. As Director of Sustainability at RATIO, Sarah works across all projects to bring rigor to the performance of their work. She leads the firm’s sustainability efforts, working to establish firm-wide and project-related sustainability goals, develop strategies and improve building performance across all projects.



**STEVE OSBORN, PE, SE, FSMPS, CPSM**  
Founder - President and CEO, CE Solutions (Moderator)  
CE Solutions, a Carmel structural engineering firm Steve founded in 1998, has grown to a professional staff of 17 providing services around the country. Steve’s experience includes two decades as a structural engineer at large, multi-disciplined firms.

PROGRAM INSIGHTS

# 9:00 AM - 2 PM

## TRADE SHOW & NETWORKING

### AEE

Association of Energy Engineers® (AEE®) “to promote the scientific and educational interests of those engaged in the energy industry and to foster action for Sustainable Development.”

[www.aeecenter.org/  
indiana-chapter](http://www.aeecenter.org/indiana-chapter)

### JOHNSON CONTROLS

Johnson Controls is a global diversified technology and multi industrial leader serving a wide range of customers in more than 150 countries.

**317-917-5000**

### Aeroseal LLC

Aeroseal seals leaks from inside the duct system with a non-toxic aerosol mist.

937-428-9300

### LANGENDORF SUPPLY CO., INC.

Supplier of innovative air distribution technology.

**317-515-8035**

### BBC PUMP AND EQUIPMENT COMPANY

Indiana's Pump & System Specialists Since 1981.

**317-672-0258**

### PERFORMANCE SERVICES

Energy Leadership Programs; Impact Assessments.

**317-603-5600**

### Belimo Americas

Belimo is the market leader in valves and actuators.

773-399-9453

### RJE Business Interiors

RJE acts as a design assist partner and a subcontractor to the General Contractor -- working together to rapidly create cost-effective, sustainable interiors that redefine the way you work.

317-293-4051

### CM BUCK & ASSOCIATES, INC.

Providing mission critical power infrastructure and cutting edge, sustainable lighting solutions for organizations.

**800-382-3961**

### Salt-Free Water Systems LLC

Green Water Conditioning systems - up to 40" pipe.

317-416-3625

### Cochrane Supply & Engineering

Your Leading Smart Building Controls Distributor. Providing products for comfort, safety, and security, as well as software development support, consultation, and training.

502-208-3640

### Schneider Electric / Square D

Metering / Overcurrent protection tied into the IOT.

317-469-1125

### COLUMBUS TEMPERATURE CONTROL

It's time to Experience Eclypse.

**614-294-6216**

### SIKA Sarnafil Roofing & Waterproofing

Roofing and Waterproofing Membranes for Green Roofs, Plaza Decks, Exposed Low & Steep Sloped Single Ply Roofing systems.

630-947-3427

### Eaton Corporation

Power management company that provides energy efficient solutions that effectively manage electrical power.

216-849-6542

### Spohn Associates, Inc.

Architectural Product Solutions - Manufacturer's Representative and Specialty Contractor.

317-921-0021

### ELITE EQUIPMENT CO., LLC

Airside Rep - Devoted to Quality & Superior Service.

**317-802-7314**

### Thermaduct

High R-Value and Low Air Leakage Duct Systems.

855-809-6903

### GUIDON

Guidon improves lives and empowers people through sustainable architecture + engineering. Based in Indianapolis, we design healthcare spaces where people can thrive.

**317-800-6388**

### Truescan 3D

Specializing in Reality Capture Services throughout the country.

317-677-2088

### HEAPY

MEP, Commissioning, Sustainability & Energy, Technology.

317-571-8795

### USGBC Indiana

USGBC Indiana promotes sustainable building design.

317-296-4220

### IHEN

Indiana Healthcare Executives Network (IHEN) serves to provide continuing education and assistance to our members, in the development of long-term, professional relationships.

[ihen.ache.org](http://ihen.ache.org)

### Viega

Global Leader in Press Technology.

800-976-9819

### Indiana-Kentucky-Ohio Regional Council of Carpenters

IKORCC introduces Fire Door Safety Inspections.

219-510-7564

**\*2019 High Performance Sponsors**

# THANK YOU HIGH PERFORMANCE SPONSORS



The goal of the Indiana Summit is to provide Education on innovative, High Performance design of the Built Environment as well as the same for the Processes and Operations of the Organizations occupying the built environment.

## To Our Attendees

Thank you for attending the 2nd Annual Indiana Innovation and High Performance Summit. As partnering organizations, we hope what you learned at today's educational sessions will assist you in integrating innovative and sustainable strategies into your everyday approach to the built environment.

## Conference Image Release:

*Attendance at, or participation in, any workshop or conference organized by the Sustainability Conference Group (SCG) / HEAPY constitutes consent to the use and distribution by SCG / HEAPY of the attendee's image or voice for informational, publicity, promotional, and/or reporting purposes in print or electronic communications media. Video recording by participants and other attendees during any portion of the workshop or conference is not allowed without special prior written permission of SCG / HEAPY. Photographs of copyrighted PowerPoint or other slides are for personal use only and are not to be reproduced or distributed. Photographs of any images labeled as confidential and/or proprietary is forbidden.*

Life Is On



*100% of the carbon emissions from the 2019 Indiana Innovation and High Performance Summit have been mitigated with renewable energy credits and carbon offsets donated by Schneider Electric. These offsets address the electricity used at the event and the carbon emissions from attendees' travel.*

*By offsetting this event, 17,227 pounds of CO2 emissions are avoided, which is equivalent to taking two passenger cars off the road for a year or planting 200 tree seedlings and growing them for 10 years.*